

# A Portion in the SW4 Sec. 13, T19N, R53E

01-12

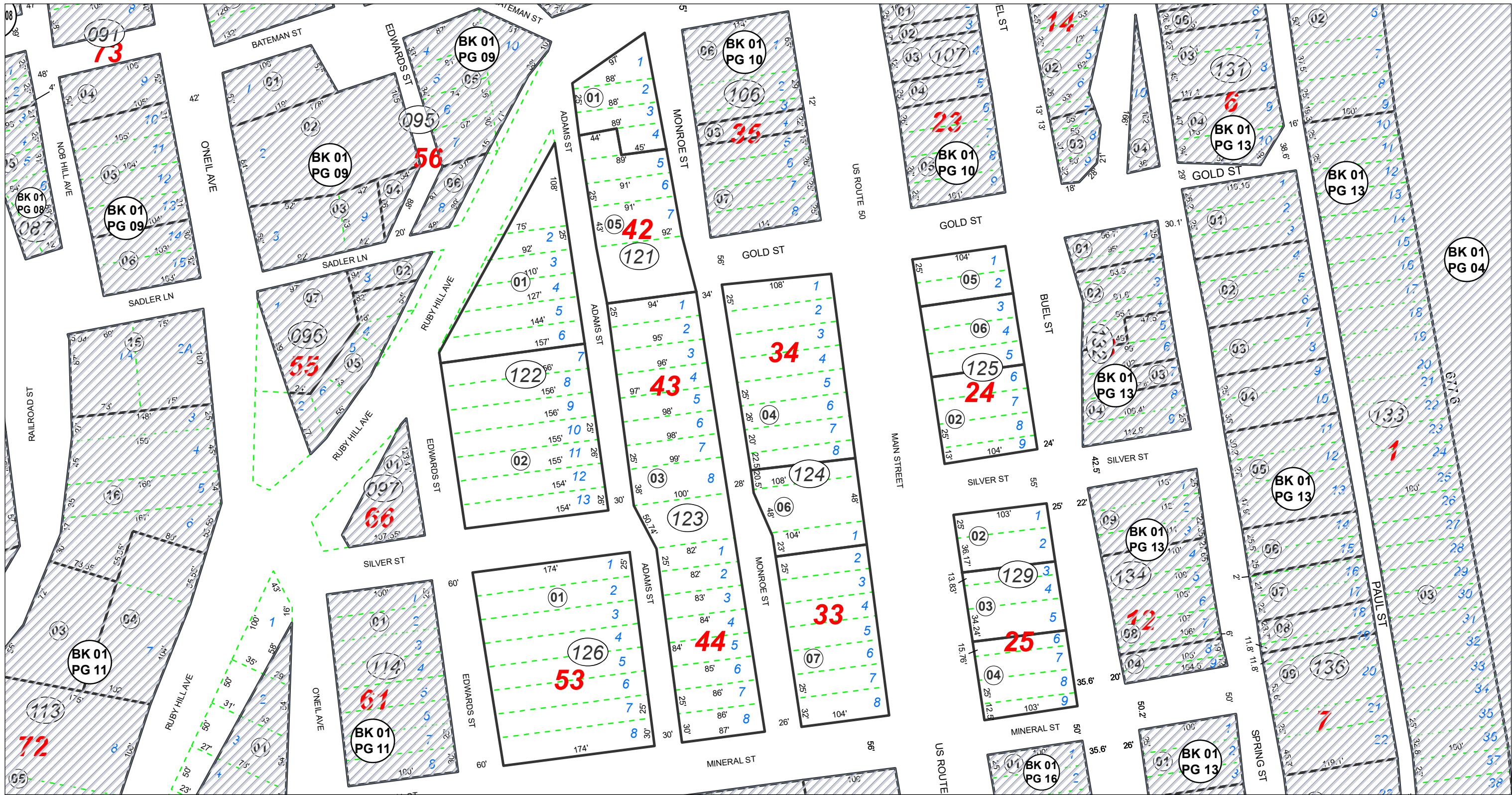

NOTE: This plat is for assessment purposes only and does not represent a survey. No liability is assumed as to the accuracy of the data delineated herein. Use of this plat for other than assessment purposes is forbidden unless approved by the Eureka County Assessor's Office.

EUREKA TOWNSITE  
1 inch = 100 feet  
EUREKA COUNTY